

**GWELER CYNLLUN DIWYGIEDIG  
SEE AMENDED PLAN**

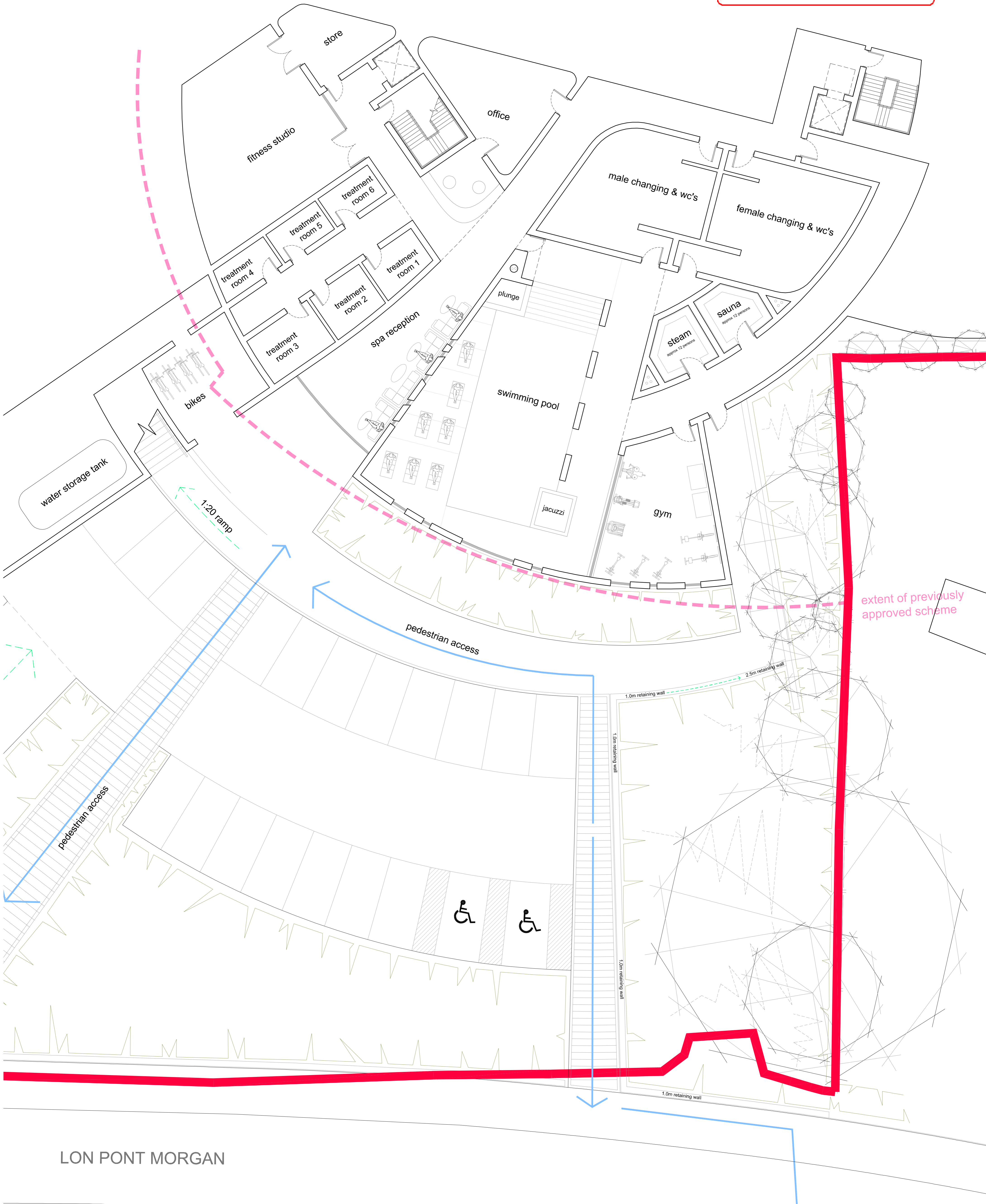

LON PONT MORGAN

Broomco (3857) Ltd  
White House Hotel

**PROPOSED LOWER GROUND FLOOR PLAN**

02.06.11 LK 1:100 @ A1

**10061 (PI) 110 E**

revision	date	drawn	description
A	15.03.12	MP	Revised layout
B	17.05.12	MP	Revised layout
C	22.05.12	MP	Minor revisions
D	06.06.12	MP	Landscaping and parking to Eastern lower ground level amended to accommodate Tree Root Protection zones.
E	30.07.12	MP	General Amendments